

COHOES FIRE DEPARTMENT

PUMPER

TID NO. 13707



BODY

- Welded Stainless Steel Body
- ROM Roll Up Doors
- Rear Slide-In Ladder and Pike Pole Storage
- Low Hosebed for Easy Access
- Storage for 8 SCBA Bottles in Wheel Wells

CHASSIS

- Spartan FC94 MFD with 10" Raised Roof
- Cummins ISL9 450 HP Engine
- 3000 EVS Transmission
- Seating for 6 Firefighters
- Back-Up Camera

TANK

- 750 Gallon UPF Tank
- ICI SL Plus Tank Gauge

PUMP

- Hale Qmax XS 1500 GPM Pump
- Fire Research Pump Boss Pressure Governor
- Front Bumper Hosewell with 1.75" Discharge
- Left side: 2.5" Discharge
2.5" Intake
Master Intake
- Right side: 2.5" Discharge
4" Discharge
Master Intake
- (3) 1.75" Crosslays
- Rear 2.5" Discharge
- Hosebed 2.5" Discharge
- Piped for Monitor

ELECTRICAL

- Fire Tech Hi Viz 72" LED Brow Light
- Whelen Warning Lighting
- Fire Research SPA530-Q20 Telescoping Lights
- Whelen LED Arrowstick
- Whelen 900 LED Scene Lights
- ILI LED Strip Compartment Lighting

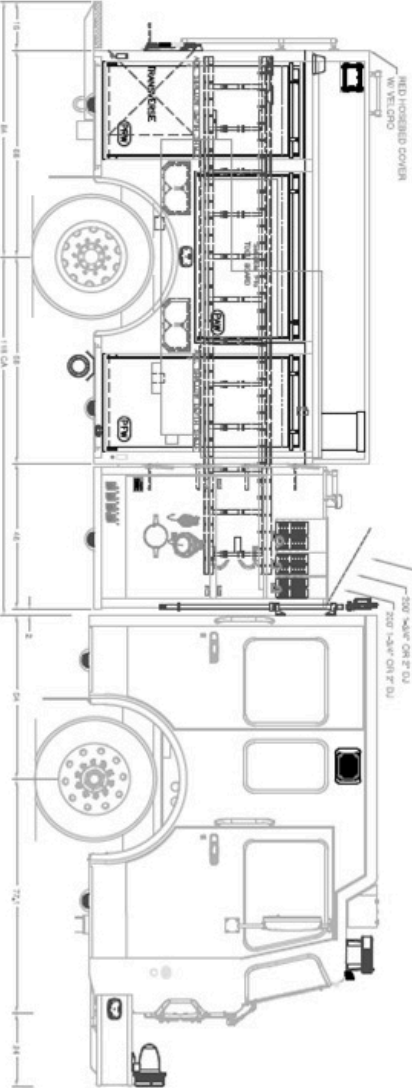
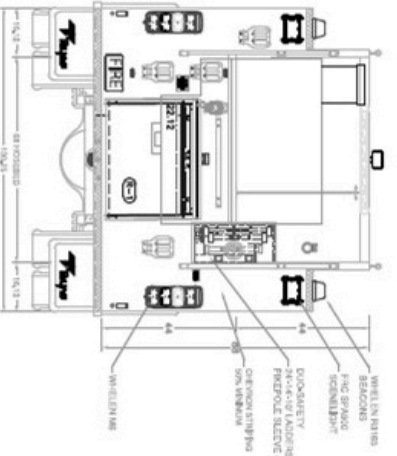

COMP	HEIGHT	WIDTH	USABLE WIDTH	USABLE LENGTH	GRADE	FT
COMP	67.12	35.88	14.00	28.00	28	23.24
D/W	37.12	63.75	14	26	28	19.18
D/W	67.12	35.88	14	26	28	20.73
P/W	67.12	35.88	14	26	28	23.24
P/W	37.12	63.75	14	26	28	19.18
P/W	67.12	32.00	14	26	28	20.73
R-1	27.88	44.00	26	26	28	29.87
HOSEBED	42	68	72	72	72	119.00
FRONT X-LAY	16	7.5	73.75	73.75	72	5.12
MIDDLE X-LAY	16	7.5	73.75	73.75	72	5.12
REAR X-LAY	16	11	73.75	73.75	72	5.12

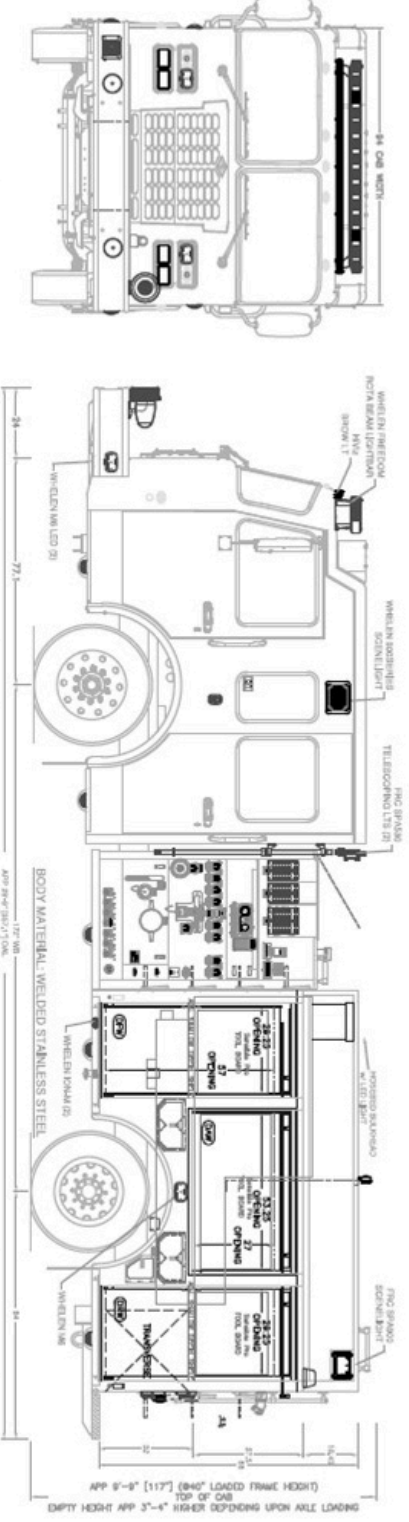
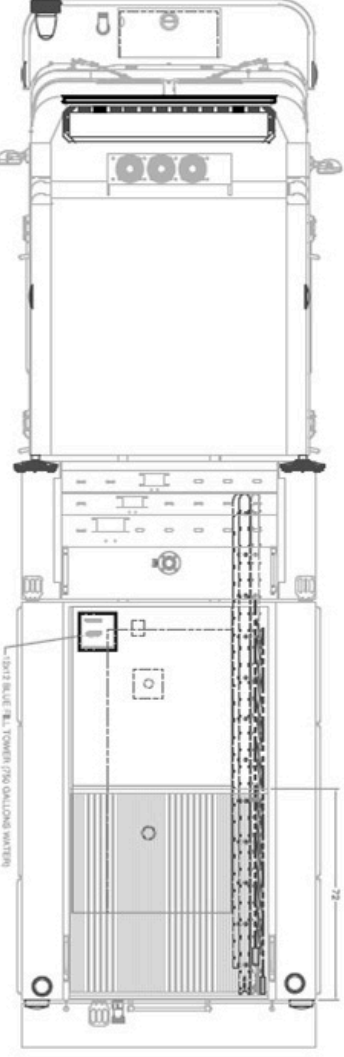

APP 8'-9" [117] (94") LOADED FRAME HEIGHT
 EMPTY HEIGHT APP 5'-4" HIGHER DEPENDING UPON AXLE LOADING

NOTE:
 DIMENSIONS SHOWN ARE APPROXIMATE AND ARE SUBJECT TO MINOR CHANGE AS MAY BE FOUND NECESSARY DURING CONSTRUCTION. MINOR DETAILS MAY NOT BE SHOWN. IF DISCREPANCIES EXIST BETWEEN THIS DRAWING AND THE WRITTEN SPECIFICATIONS PROVIDED BY TOWN, THE WRITTEN SPECIFICATIONS SHALL PREVAIL.

ORIGINAL DRAWING	24MAR21	CHASSIS:	SPARTAN FC-94 MFD 10' RR
ISR	22NOV22	WB-CAN-F:	172-118-98" D17
REV A	28NOV22	BODY MATL:	WELDED STAINLESS STEEL
CO I	03FEB23	PUMP:	HALE OMAX-XS 1500
AS BUILT TANK	29DEC23	TANK:	750 "L" UP POLY-TANK III
FOAM SYSTEM:	N/A	GENERATOR:	N/A

SCALE:	1/66	SHEET:	A
CITY:	COHOES		
STATE:	NY		
DIRE:	VNS		
CAD:	GROSSMAN		
DATE:	24 MARCH 2021		
FILE:	COH0ES21		

COHOES
 CUSTOM PUMPER
 BREDA, IA 51436
 800-648-3358
 WWW.TOYNE.COM